

CORE & SHELL

ENTIRE 5TH FLOOR 29,212 RSF

AVAILABLE 7/1/2022

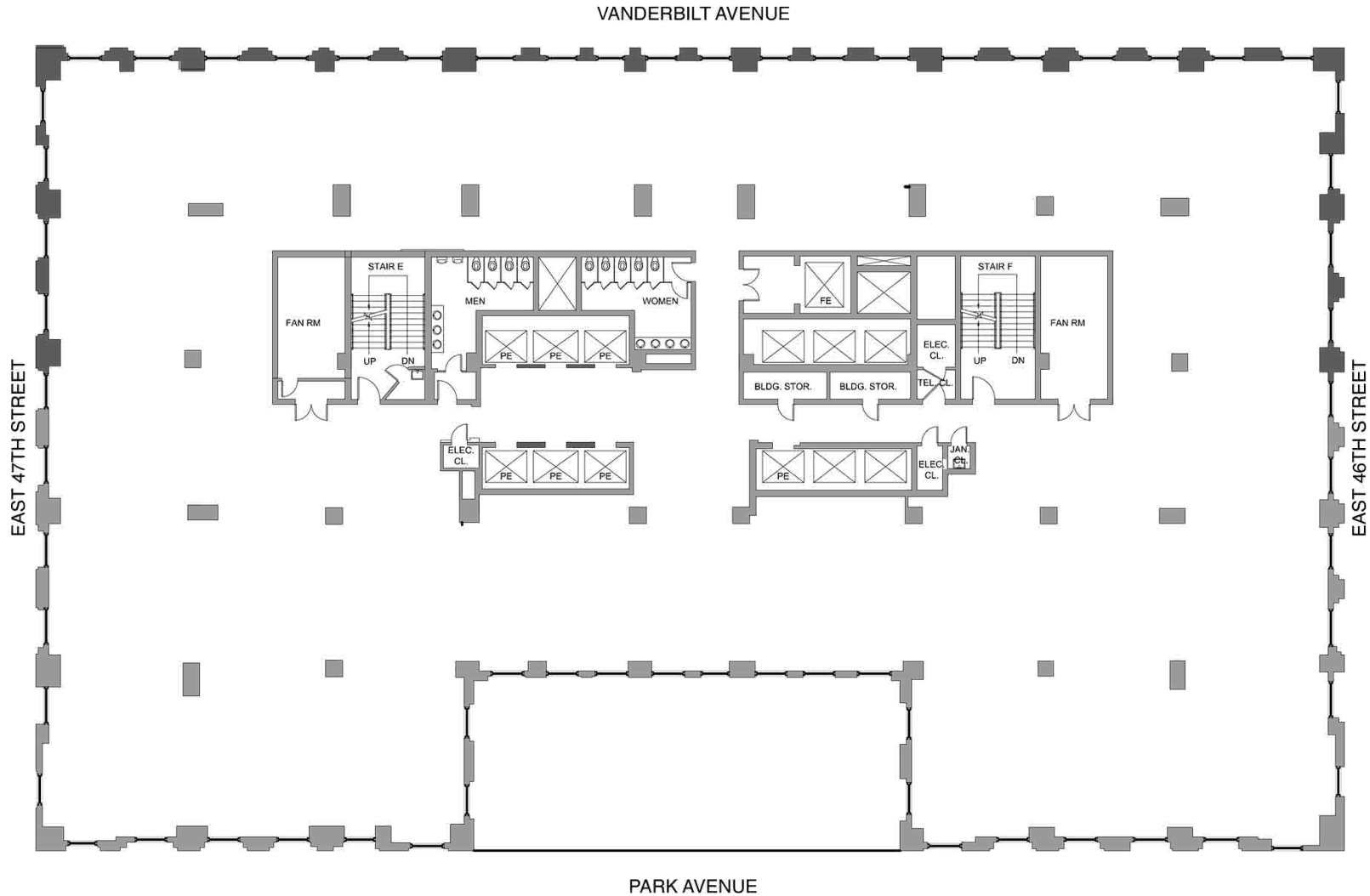

250parkave.com
David L. Hoffman Jr. | 212.318.9767 | David.Hoffman@cushwake.com
Whitnee Williams | 212.954.0920 | Whitnee.Williams@cushwake.com

250
PARK AVENUE

PROPOSED LAYOUT

ENTIRE 5TH FLOOR 29,212 RSF

AVAILABLE 7/1/2022



LEGEND	
RECEPTION	1
WORK STATIONS	23
WORK BENCH	58
BOARD ROOM (20)	1
PRIVATE OFFICE	42
CONF. ROOM (10)	1
CONF. ROOM (8)	2
CONF. ROOM (5)	2
PANTRY	2
WELLNESS ROOM	1
STORAGE ROOM	4
IT ROOM	1
STORAGE CLOSET	4
COPY ALCOVE	3
COPY ROOM	2
BISTRO	1



250parkave.com
 David L. Hoffman Jr. | 212.318.9767 | David.Hoffman@cushwake.com
 Whitnee Williams | 212.954.0920 | Whitnee.Williams@cushwake.com

250
 PARK AVENUE