

CORE & SHELL

ENTIRE 3RD FLOOR 31,813 RSF

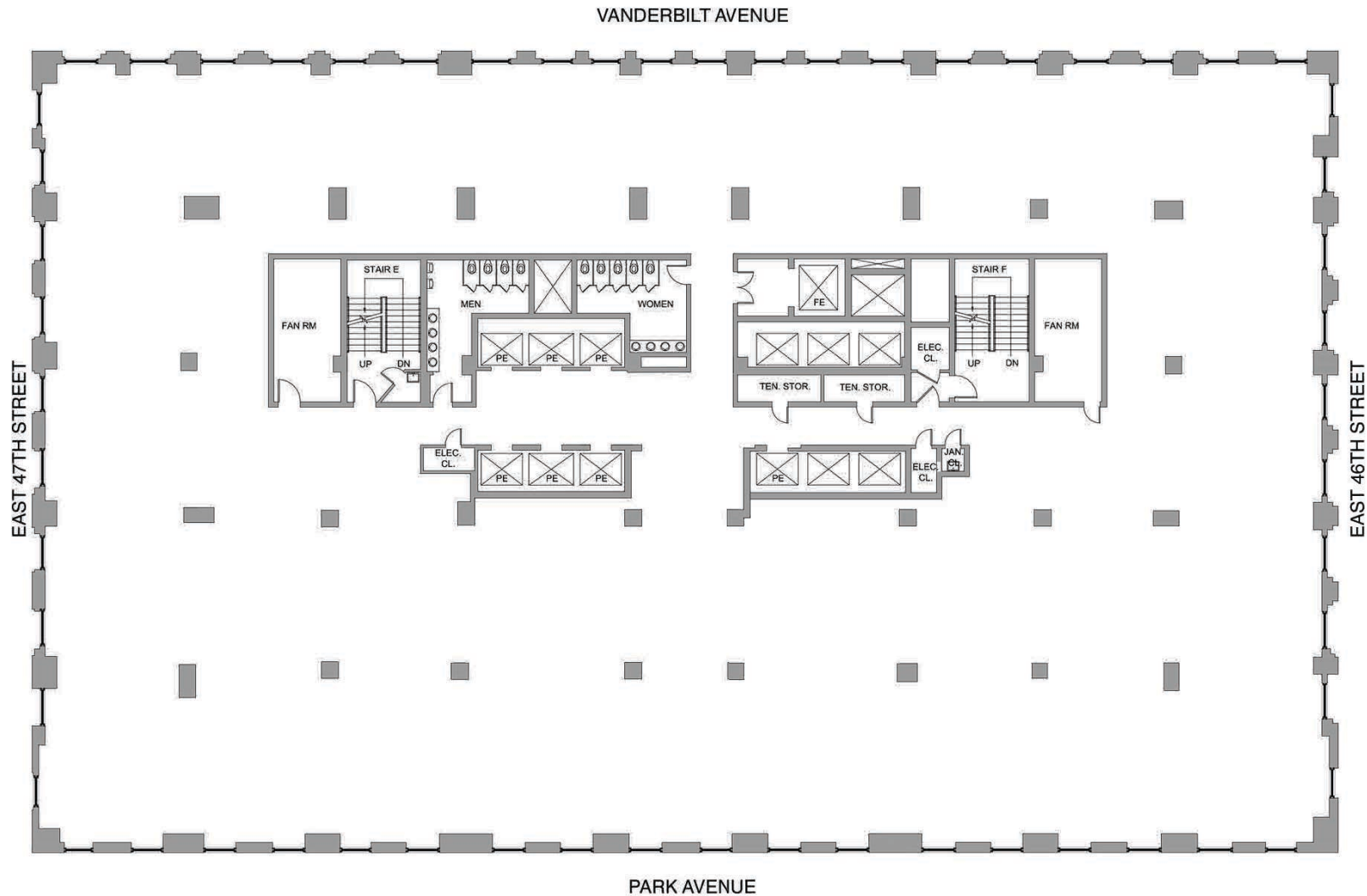

250parkave.com

David L. Hoffman Jr. | 212.318.9767 | David.Hoffman@cushwake.com

Whitnee Williams | 212.954.0920 | Whitnee.Williams@cushwake.com

250
PARK AVENUE

PROPOSED LAYOUT

ENTIRE 3RD FLOOR 31,813 RSF



LEGEND	
RECEPTION	1
WORK STATIONS	59
WORK BENCH	18
PRIVATE OFFICE	60
CONF. ROOM (10)	2
CONF. ROOM (8)	1
PANTRY	2
MAIL ROOM	1
COPY ROOM	2
STORAGE ROOM	3
COPY ALCOVE	3
IT ROOM	1



250parkave.com
 David L. Hoffman Jr. | 212.318.9767 | David.Hoffman@cushwake.com
 Whitnee Williams | 212.954.0920 | Whitnee.Williams@cushwake.com

250
 PARK AVENUE

ENTIRE 3RD FLOOR MULTI-TENANT DEMISED

SUITE 1	TOTAL
RECEPTION	1
CONF. ROOM(10)	1
CONF. ROOM(14)	1
MEETING ROOM	1
PRIVATE OFFICE	21
WORK BENCH	34
WORK LOUNGE	2
ZOOM ROOM	2
BISTRO	1
COPY ROOM	1
IT CLOSET	1

SUITE 2	TOTAL
RECEPTION	1
CONF. ROOM(10)	1
CONF. ROOM(14)	1
MEETING ROOM(4)	3
PRIVATE OFFICE	19
WORK BENCH	73
ZOOM ROOM	3
PANTRY	1
COPY ROOM	1
IT ROOM	1
STORAGE ROOM	1

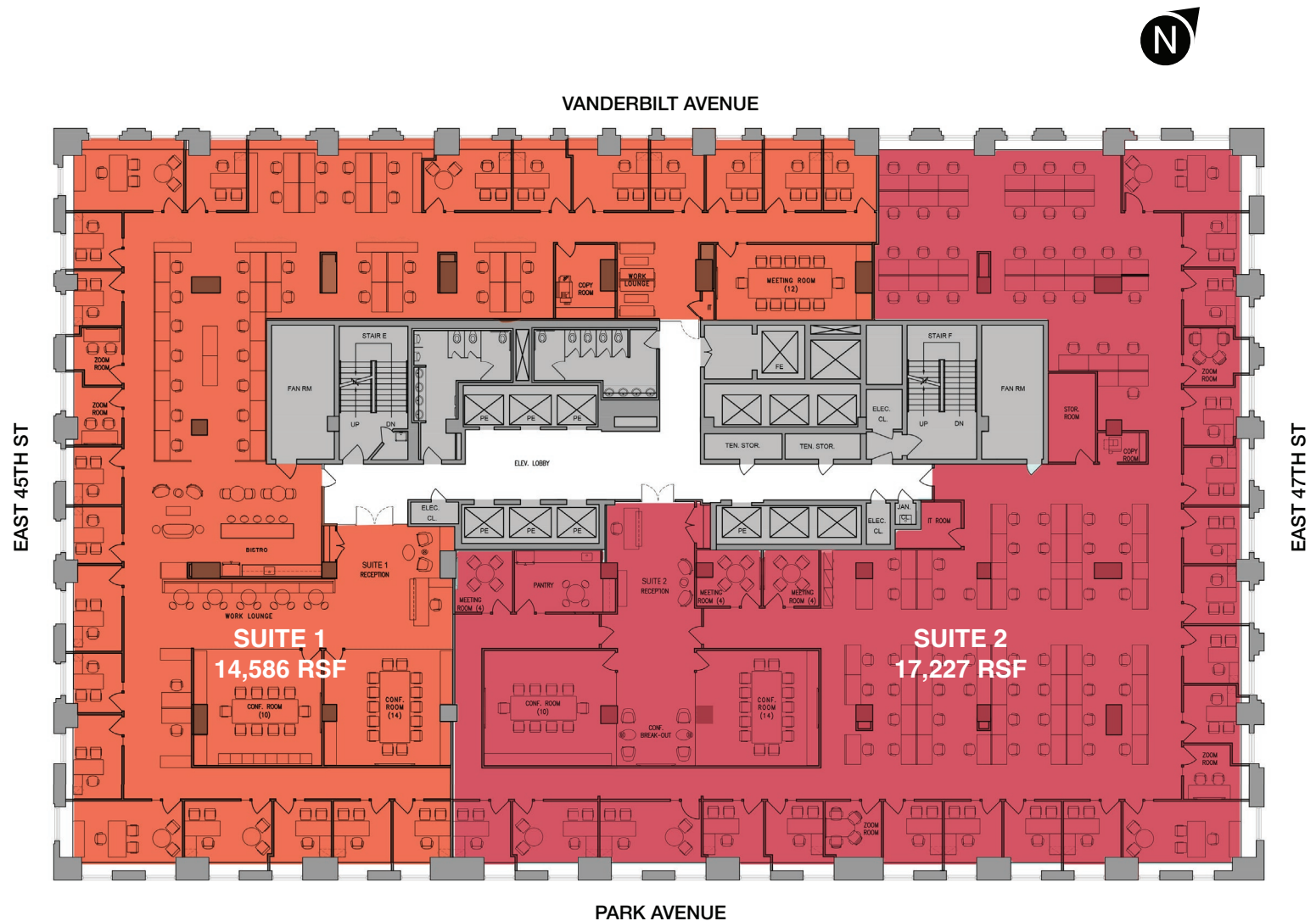

250parkave.com
 David L. Hoffman Jr. | 212.318.9767 | David.Hoffman@cushwake.com
 Whitnee Williams | 212.954.0920 | Whitnee.Williams@cushwake.com

250
 PARK AVENUE