

CORE & SHELL

ENTIRE 5TH FLOOR 29,212 RSF

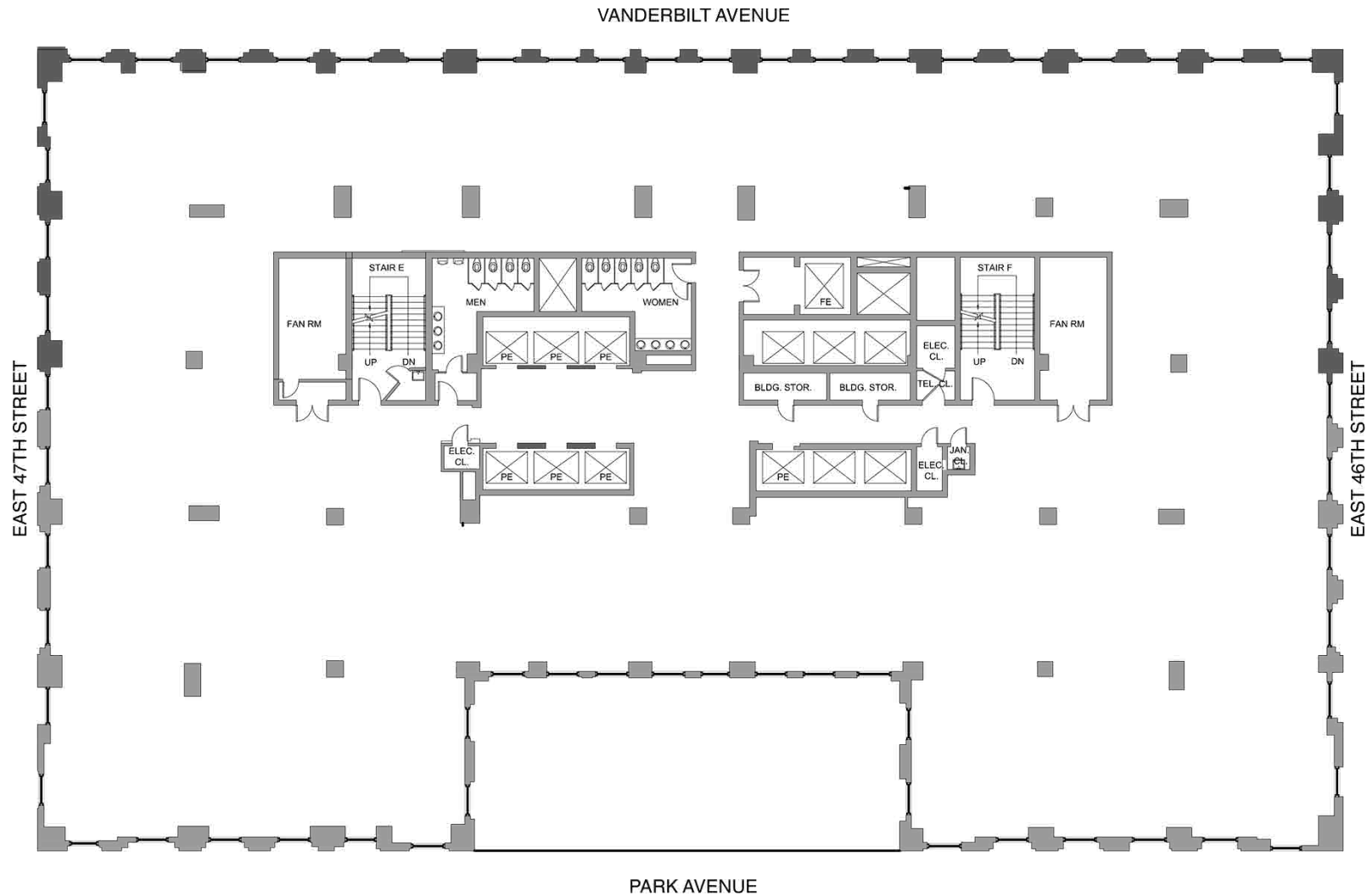

250parkave.com

David L. Hoffman Jr. | 212.318.9767 | David.Hoffman@cushwake.com

Whitnee Williams | 212.954.0920 | Whitnee.Williams@cushwake.com

250
PARK AVENUE

PROPOSED LAYOUT

ENTIRE 5TH FLOOR 29,212 RSF



LEGEND	
RECEPTION	1
WORK STATIONS	23
WORK BENCH	58
BOARD ROOM (20)	1
PRIVATE OFFICE	42
CONF. ROOM (10)	1
CONF. ROOM (8)	2
CONF. ROOM (5)	2
PANTRY	2
WELLNESS ROOM	1
STORAGE ROOM	4
IT ROOM	1
STORAGE CLOSET	4
COPY ALCOVE	3
COPY ROOM	2
BISTRO	1



250parkave.com
 David L. Hoffman Jr. | 212.318.9767 | David.Hoffman@cushwake.com
 Whitnee Williams | 212.954.0920 | Whitnee.Williams@cushwake.com

250
 PARK AVENUE

ENTIRE 5TH FLOOR MULTI-TENANT DEMISED

SUITE 1	TOTAL
RECEPTION	1
CONF. ROOM(6)	1
CONF. ROOM(8)	1
MEETING ROOM(4)	1
PRIVATE OFFICE	16
WORK BENCH	71
ZOOM ROOM	4
PANTRY	1
QUIET ROOM	1
COPY ROOM	3
IT ROOM	1
STORAGE ROOM	2

SUITE 2	TOTAL
RECEPTION	1
BOARD ROOM(24)	1
CONF. ROOM(8)	1
MEETING ROOM(2)	1
MEETING ROOM(6)	2
PRIVATE OFFICE	14
WORK BENCH	27
WORK LOUNGE	1
ZOOM ROOM	7
BISTRO	1
PANTRY	1
COPY ROOM	2
IT ROOM	1
STORAGE ROOM	2

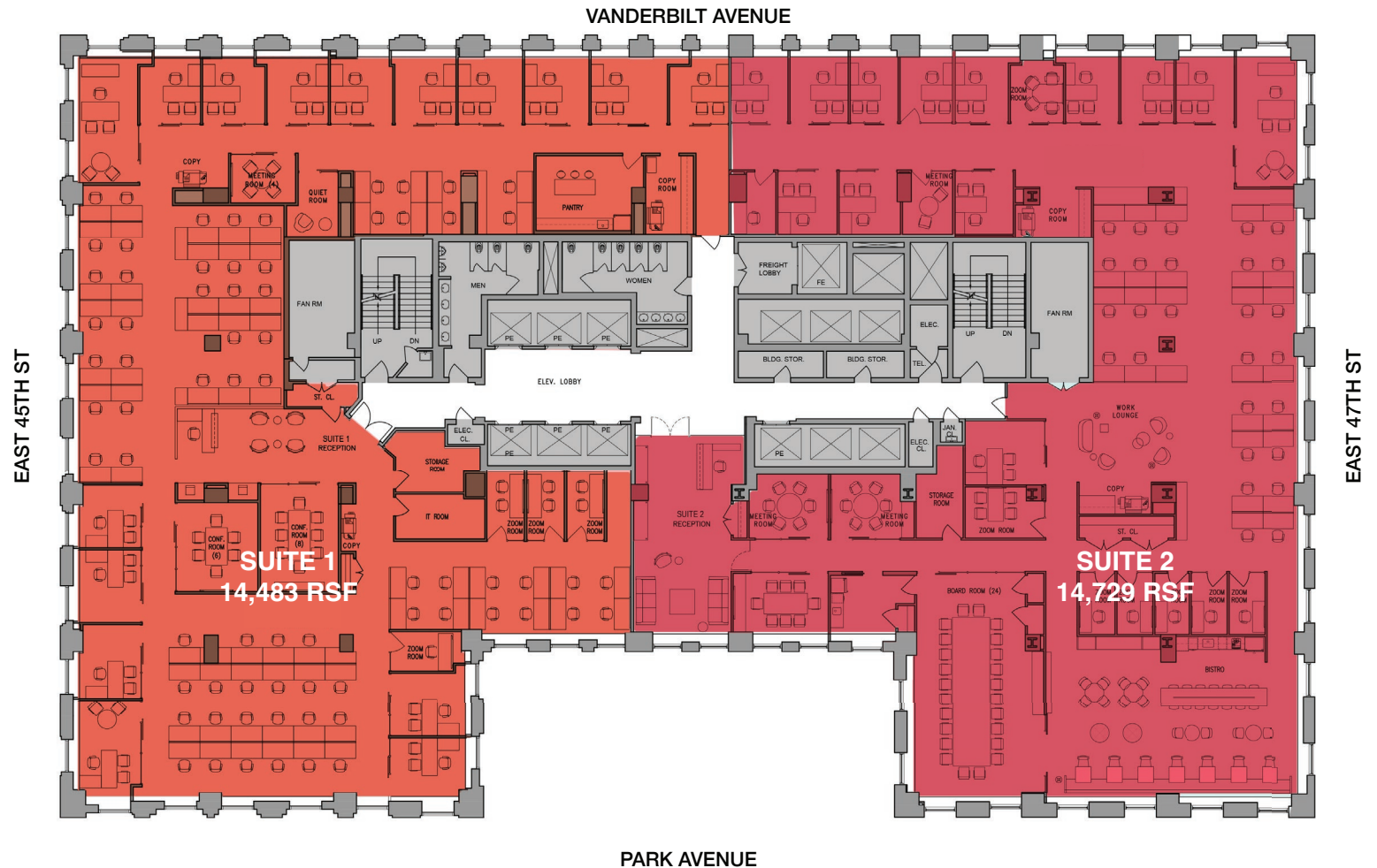

250parkave.com
 David L. Hoffman Jr. | 212.318.9767 | David.Hoffman@cushwake.com
 Whitnee Williams | 212.954.0920 | Whitnee.Williams@cushwake.com

250
 PARK AVENUE